

COLLECT_{AND}DRAIN Model 5200K Assembly Instructions

COLLECT_{AND}DRAIN Model 5200K Field Assembly Kit includes:

- (2) Model 5100BV 1" NPT Ball Valve
- (2) U-bolt
- (2) Saddle
- (4) $\frac{3}{4}$ " x $\frac{5}{16}$ "-18 Coupling Nut
- (4) $\frac{3}{8}$ " Nylon Flange Bushing
- (1) Anti-Trip Plate
- (4) $\frac{3}{8}$ " Nylon Washer
- (4) $\frac{5}{16}$ "-18 Socket Head Screw Cap
- (2) Ball Valve Handle
- (2) Valve Handle Lock Nut

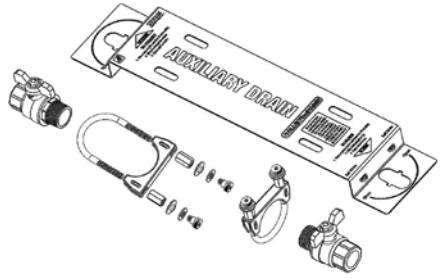

The following items are not included in the COLLECT_{AND}DRAIN Model 5200K Field Assembly Kit but are necessary to complete the assembly:

- (2) 2" x 1" Reducer
- (1) 2" x 12" Nipple
- (1) 1" Plug or Nipple and Cap

Valve and Pipe Assembly

1. Auxiliary drain is to be assembled to comply with NFPA 13 8.16.2.5.3.5 (two 1" valves, 2" x 12" nipple or equivalent, plug or nipple with cap).
2. Pipe fittings per ANSI B.16, pipe threads and installation of pipe fittings per ANSI B1.20.1. The use of a pipe thread sealant is suggested. The use of Teflon[®] tape to obtain seal is not recommended.
3. Assemble reducers (Item 1) onto 2" nipple (Item 2) to a dimension of $10\frac{3}{4}$ " \pm $\frac{1}{32}$ " between reducers. See Figure 1.
4. Assemble M5100BV (Item 3) aligned to each other with a stem to stem dimension of $18\frac{7}{8}$ " - 19" with male 1" NPT threaded into reducer (Item 1). See Figure 1.

Anti-Trip Plate Assembly

1. After valve and pipe assembly is complete, attach U-bolt (Item 5) and saddle (Item 6) to the 2" nipple (Item 2) with coupling nuts (Item 7). Ensure saddles are flush to reducer and centered with valve stems.

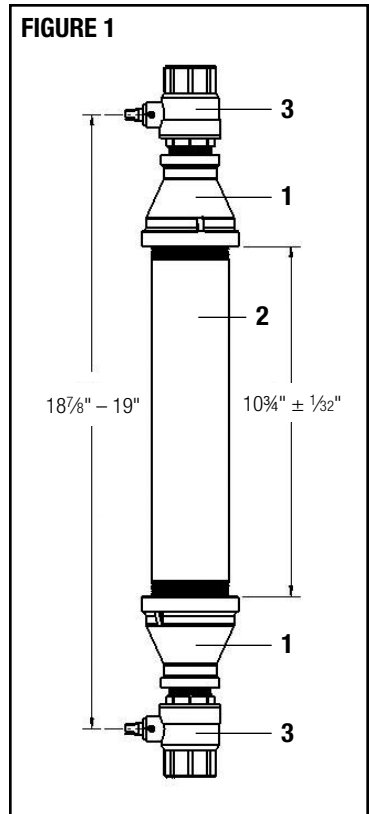

2. Attach anti-trip plate (Item 9) to valve and pipe assembly with labeling facing outward. Ensure valve ends of anti-trip plate are below handle stops. See Figure 2, Detail A.
3. Fasten anti-trip plate to coupling nuts as shown in Figure 2, Detail B.
 - a. Flange bushing (Item 8) behind anti-trip plate (Item 9) and flush against coupling nut (Item 7).
 - b. Washer (Item 10) on label side of anti-trip plate (Item 9).
 - c. Socket head screw cap (Item 11) threaded through: washer (Item 10), anti-trip plate (Item 9), flange bushing (Item 8) and coupling nut (Item 7).
4. Attach one valve handle (Item 12) to drain side (lower) valve with valve handle lock nut (Item 13). Thread 1" plug (Item 5) into drain side valve.
5. Close drain side valve. Slide anti-trip plate down tight to drain side valve handle.
6. Attach remaining valve handle (Item 12) to system side (upper) valve with valve handle lock nut (Item 13).
7. Open system side valve.
8. The COLLECTANDRAIN assembly is ready for installation. Refer to Operator's Manual for operation and maintenance.

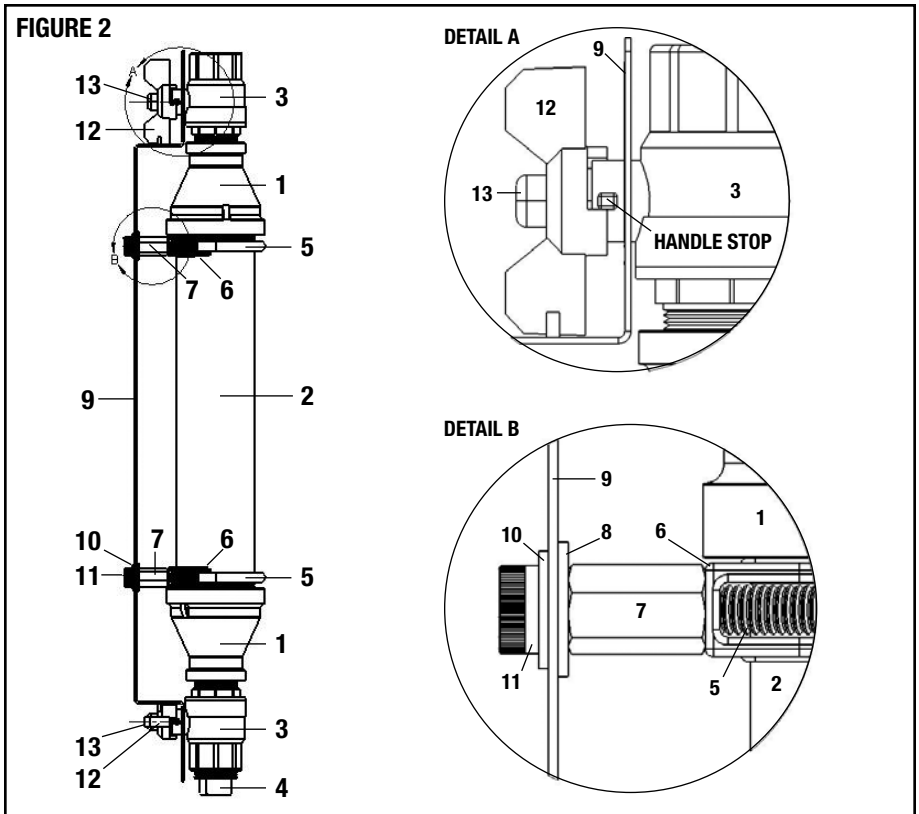

COLLECT_{AN}DRAIN

Model 5200A

Anti-Trip Auxiliary Drain and Condensation Collection Assembly for
Dry Pipe and Preaction Fire Sprinkler Systems

Operator's Manual



AGF Manufacturing Inc.
100 Quaker Lane, Malvern, PA 19355

Phone: 610-240-4900

Fax: 610-240-4906

www.testandrain.com

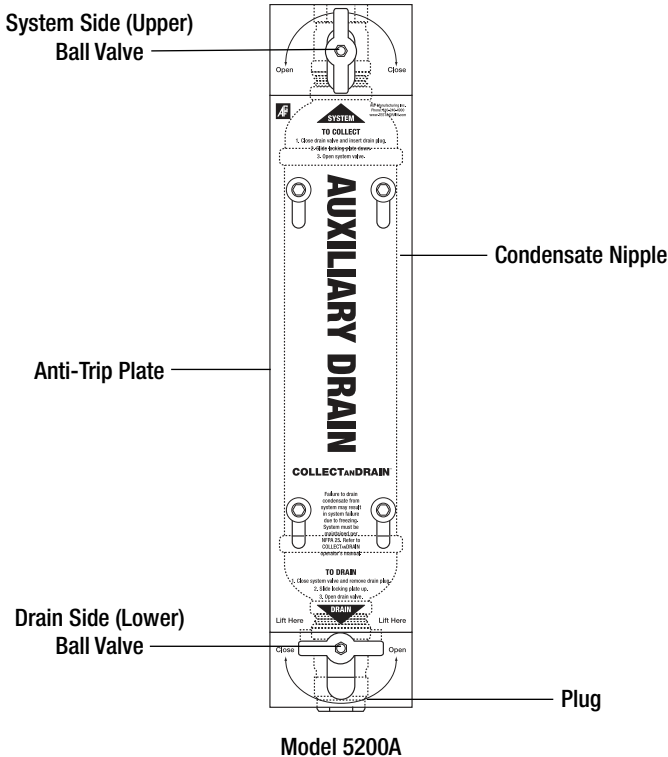

Installation Instructions

To Install in an Existing System

For adding additional installations see NFPA 13 Chapters 24 and 26 and NFPA 25 Chapter 14.

1. Isolate branch line or zone where COLLECTANDRAIN is to be installed.
2. Relieve air pressure from branch line.
3. Remove existing auxiliary drain / condensation collection assembly.
4. Install assembled COLLECTANDRAIN by attaching the system side (upper) ball valve in accordance with NFPA 13 8.16.2.5 and 8.16.2.5.3 in regards to low point drains.
5. Confirm that system side (upper) valve is in the open position and ready to collect condensation and that the drain side (lower) valve is closed and the valve plug is tight.
6. Return system back to normal operating conditions.

To Install in a New System

1. Install assembled COLLECT_{AND}DRAIN by attaching the system side (upper) ball valve in accordance with NFPA 13 8.16.2.5 and 8.16.2.5.3 in regards to low point drains.
2. Confirm that system side (upper) valve is in the open position and ready to collect condensation and that the drain side (lower) valve is closed and the valve plug is tight.
3. Activate system for normal operating conditions.

Operation and Maintenance

WARNING: The COLLECT_{AND}DRAIN is designed to prevent the accidental tripping of a dry valve by requiring that the valves of a condensation collector be operated in the correct manner and sequence. COLLECT_{AND}DRAIN is not designed to prevent freezing or automatically drain condensation from the system. Failure to drain condensation from system may result in catastrophic system failure due to freezing. System must be maintained per NFPA 25 4.6, 4.6A and 4.1.

To Collect Condensate per NFPA 25 A.12.4.3.3.3

The normal setting of the COLLECT_{AND}DRAIN assembly is to have the system side (upper) valve be in the “open” position (valve tee handle in line with COLLECT_{AND}DRAIN assembly) and the drain side (lower) valve be in the “closed” position (valve tee handle perpendicular with COLLECT_{AND}DRAIN assembly). The 1" plug should be threaded into outlet of the drain side (lower) valve. The Anti-Trip Plate should be at its lowest position and, if equipped, the anti-tamper lock should be installed.

To Drain Condensate per NFPA 25 A.12.4.3.3.3

1. Close the system side (upper) valve and remove drain plug.
2. Slide the anti-trip plate to its highest position.
3. Open the drain side (lower) valve and drain the accumulated water.
4. Once the water has been drained, close the drain side (lower) valve and slide the anti-trip plate to its lowest position.
5. Open the system side (upper) valve and allow time for additional water to accumulate.
6. Repeat the process until all of the accumulated water has been drained.
7. Once all water has been drained, return the COLLECT_{AND}DRAIN to

the “COLLECT” position by closing the drain side (lower) valve, put new Teflon® tape on 1" plug and reinstall into outlet of drain side (lower) valve, slide the Anti-Trip plate to its lowest position and open the system side (upper) valve, reinstall anti-tamper lock if equipped.

Thank You For Using Our Products!

For our complete family of products, visit
us online at www.testandrain.com.